

Bill Bedford Models

BCK8004 BR D.1/210 CovHop

Assembly suggestions

Solebars

While the construction of the brass item would normally be done using solder, once the resin body is in place all subsequent assembly must be using glue. Cyanoacrilate (superglue) is recommended. As an alternative it is perfectly possible for all the assembly to be carried out with glue

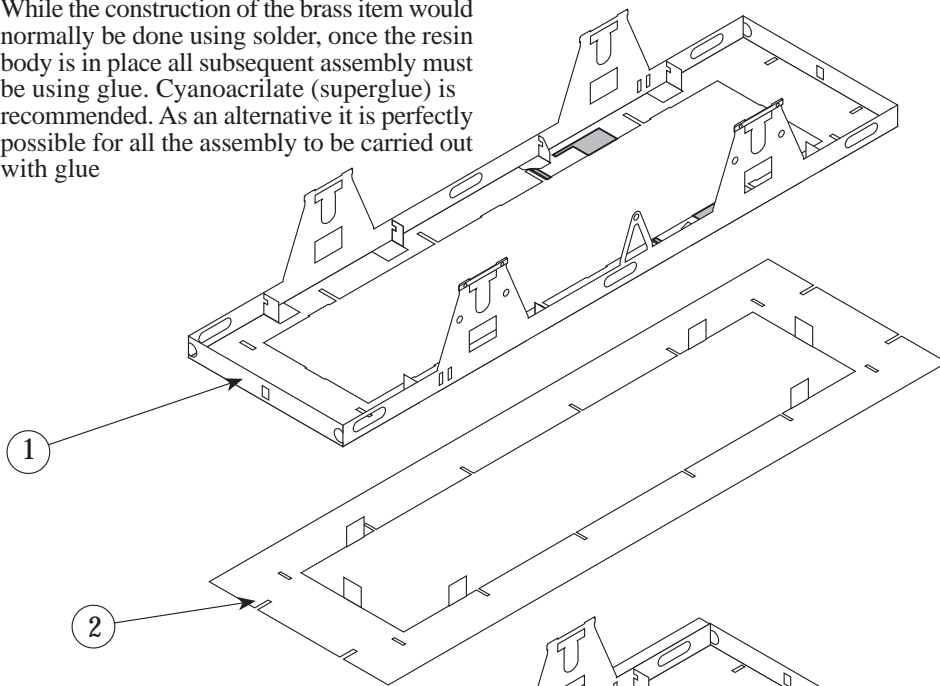

Break off location tabs after top plate and frame have been fix together

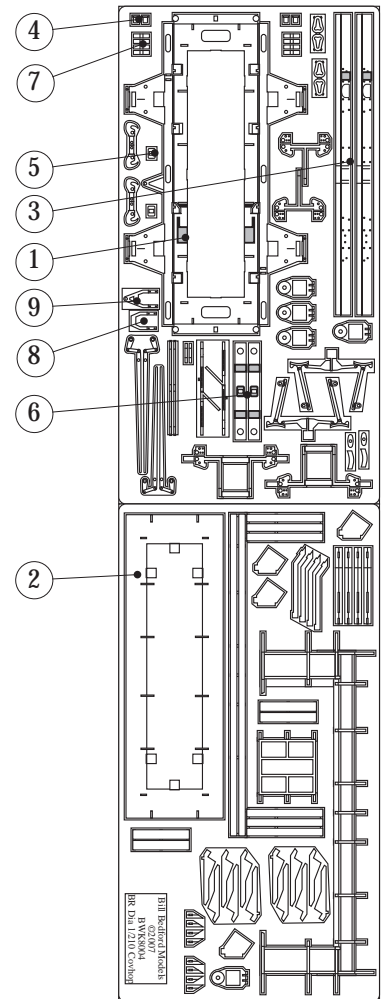
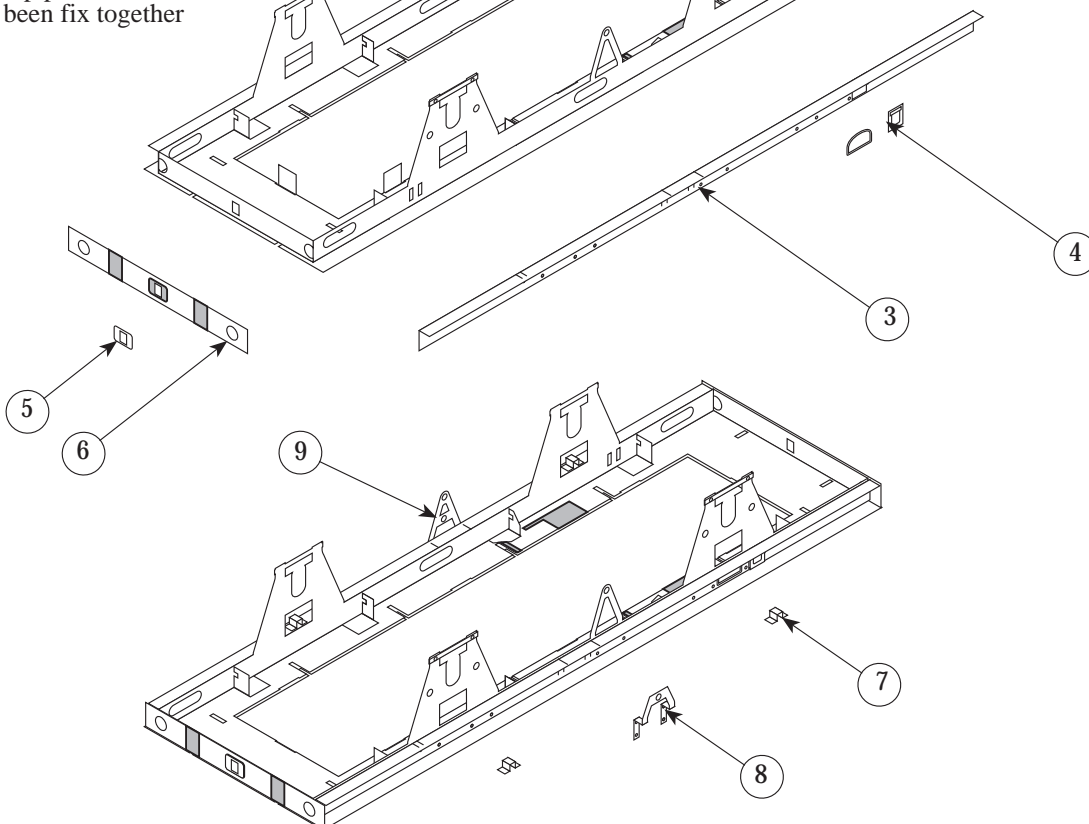

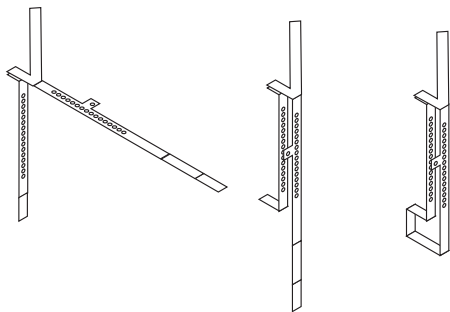
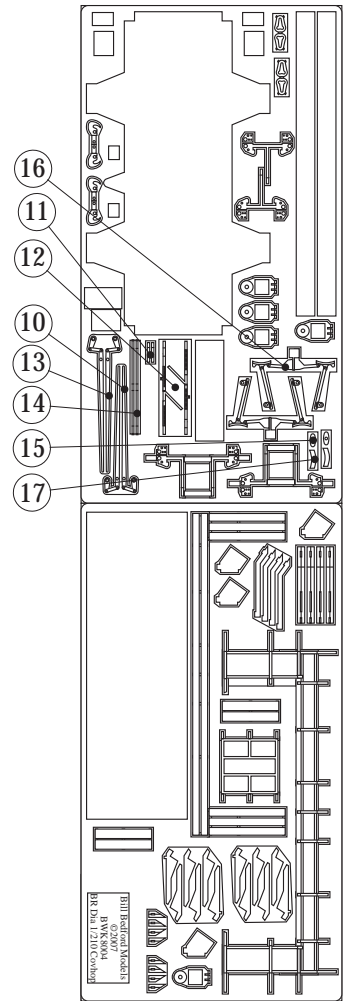
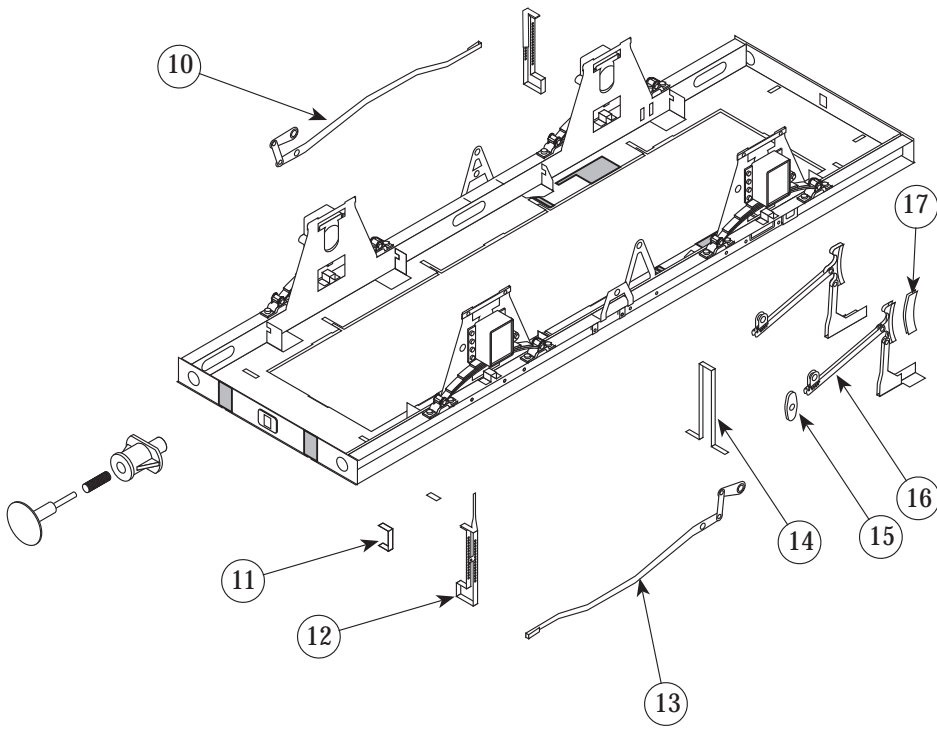

Folding the brake lever guides

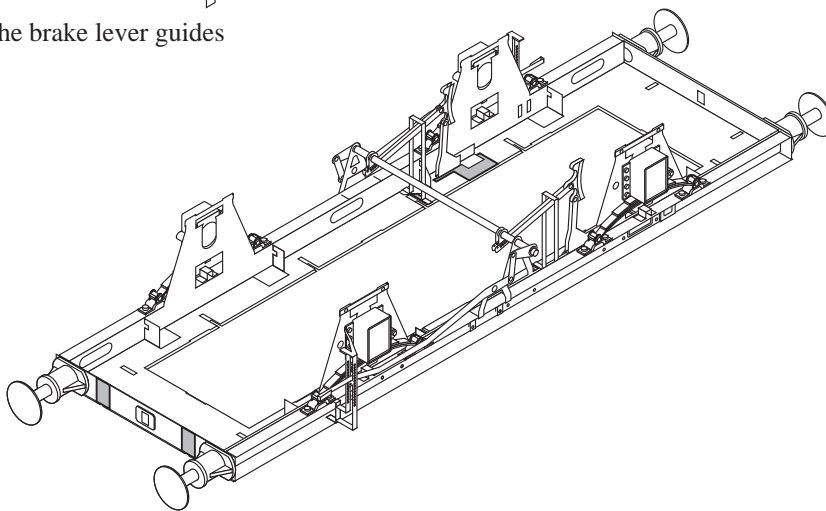

Body

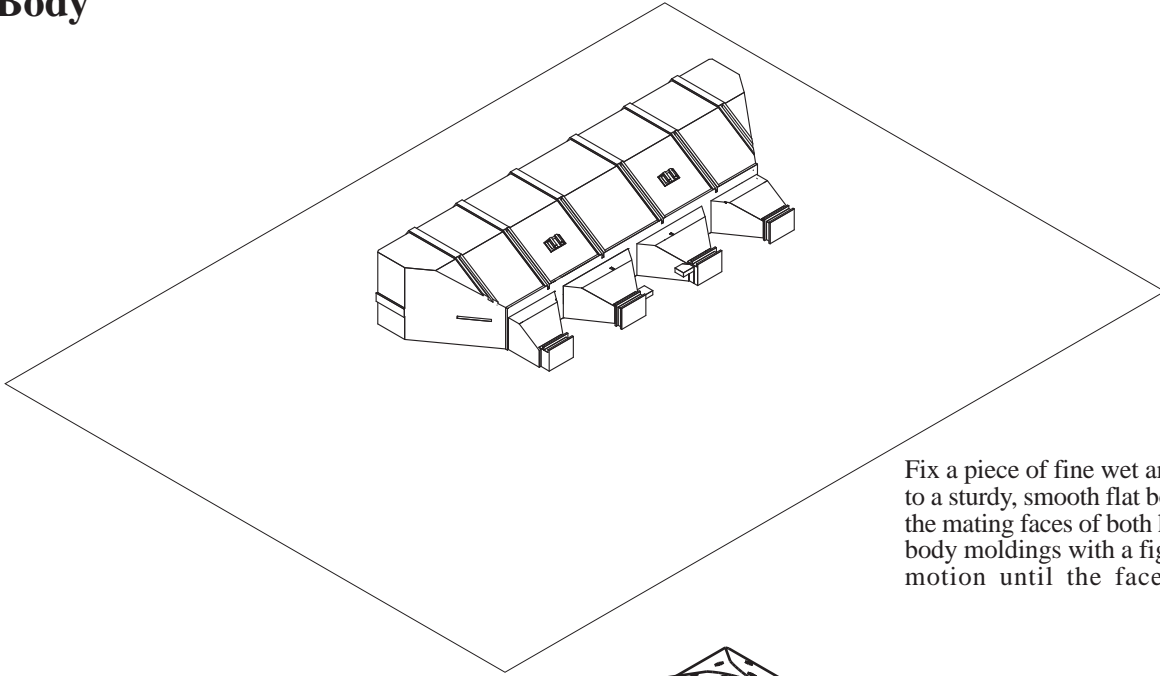

Fix a piece of fine wet and dry paper to a sturdy, smooth flat board and rub the mating faces of both halves of the body moldings with a figure of eight motion until the faces are true.

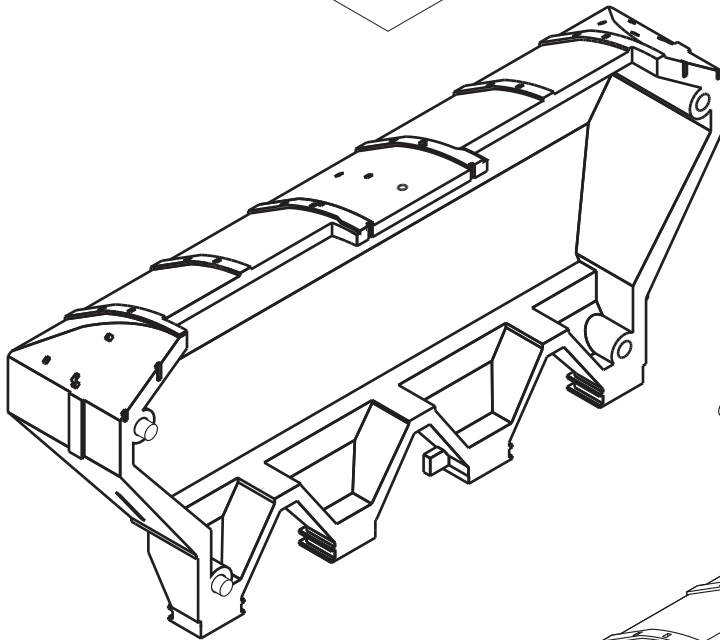

Place short lengths of plastic rod into location holes in one body half to form location pins. These pins should protrude no more than 2-3 mm.

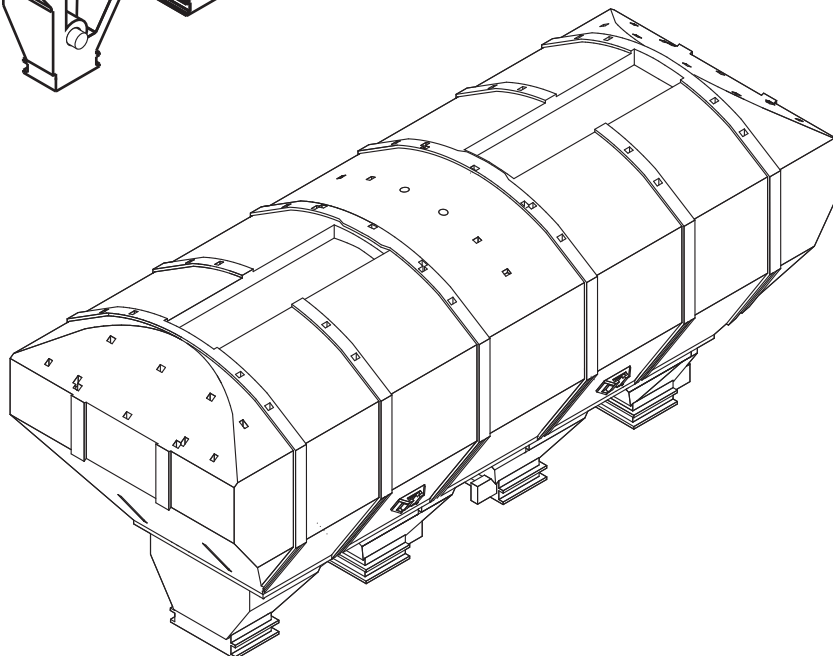

Suspension

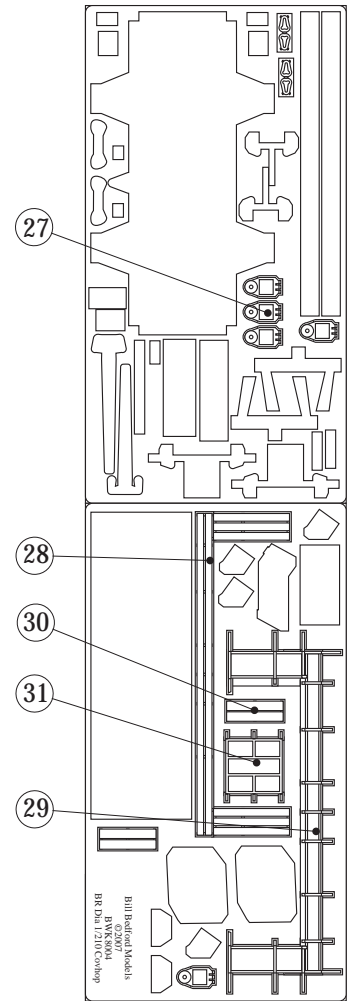
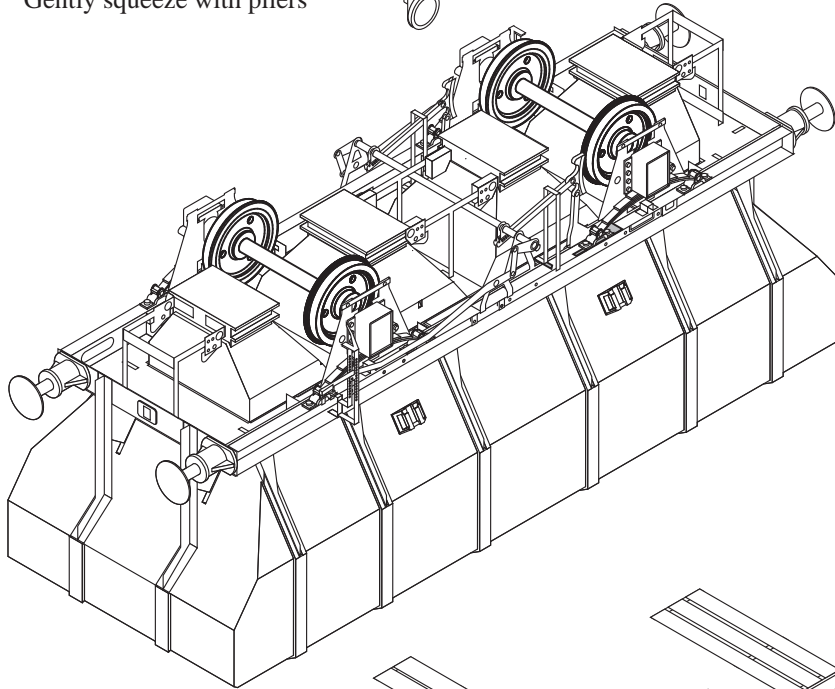
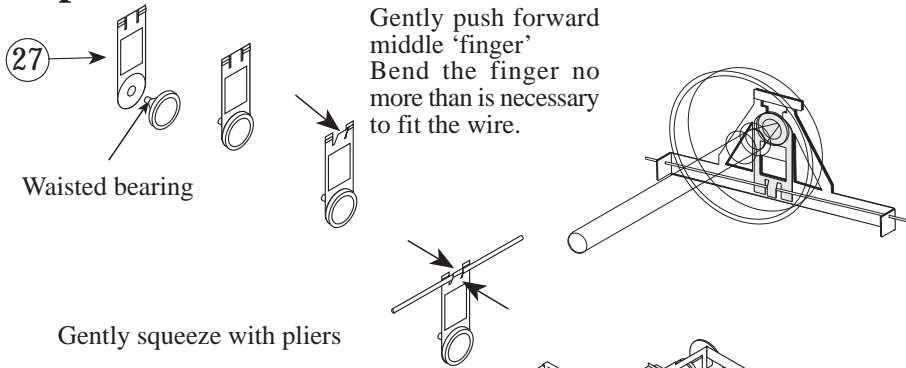

Walkways

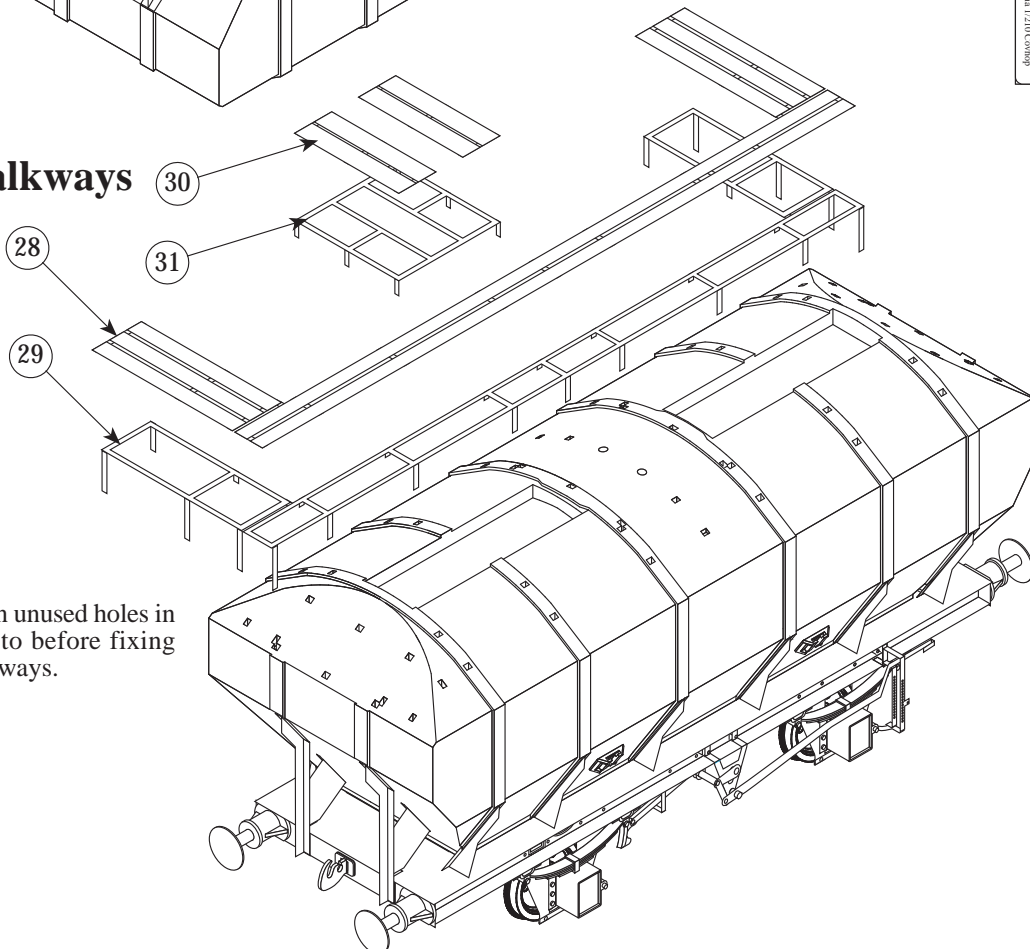

Fill in unused holes in tank to before fixing walkways.

Finishing

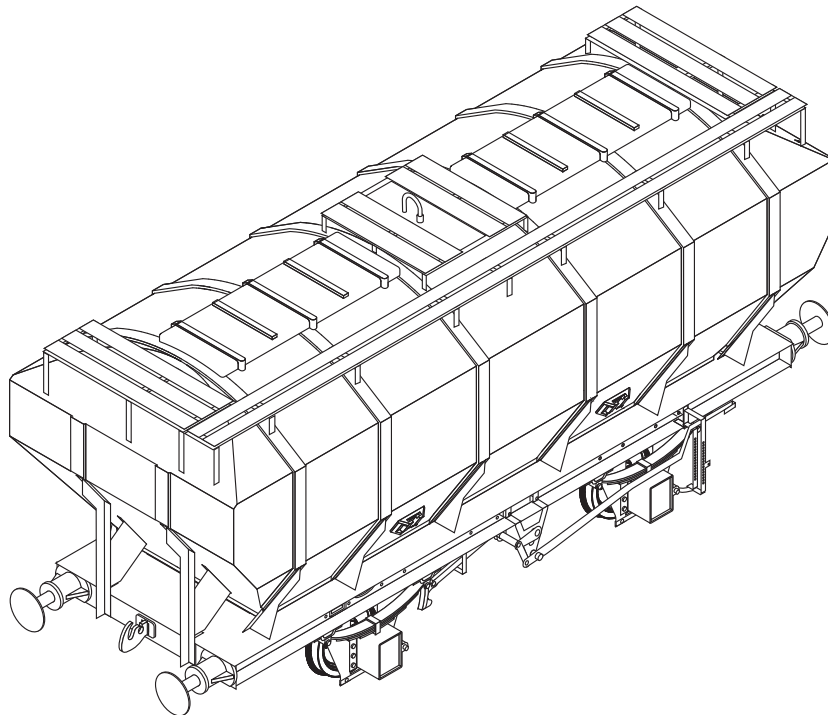
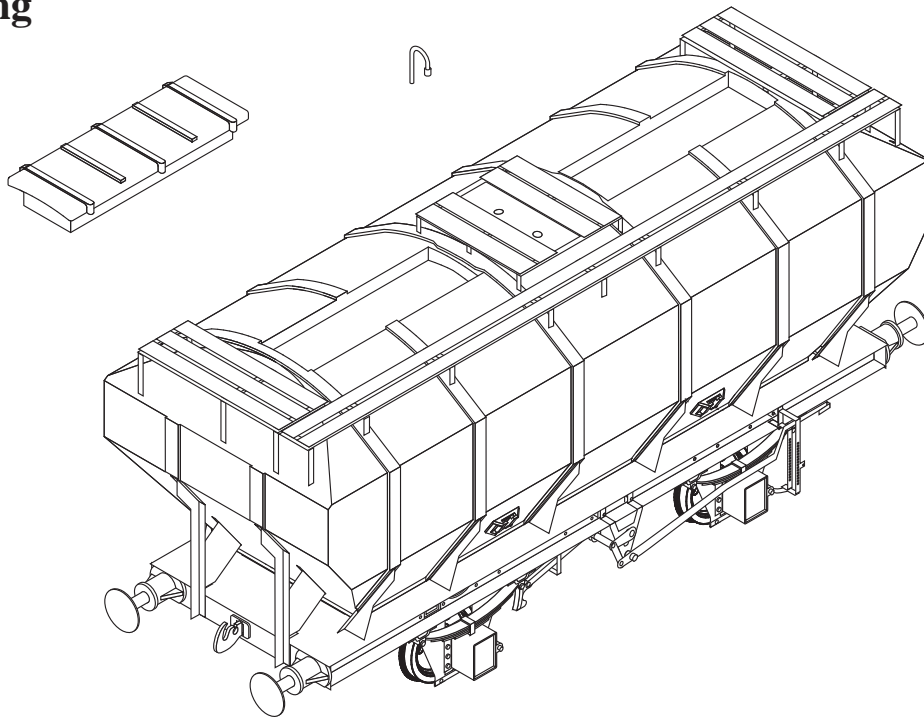

Note Buffers

This kit contains some new, more prototypical buffers, Unfortunately only solid ones are available at the moment, however heads and springs have been included for those who would wish to drill out the housings.

For sprung buffers cut off the buffer head a spindle and reduce the overall length of the casting to 7mm. Drill a 1mm hole 6mm deep from the head end and then drill through the remaining solid metal of the housing 0.5mm diameter.