

Bill Bedford Models

LFF1001 LMS 3F 0-6-0T 'Jinty' Frames

Assembly suggestions

Frames

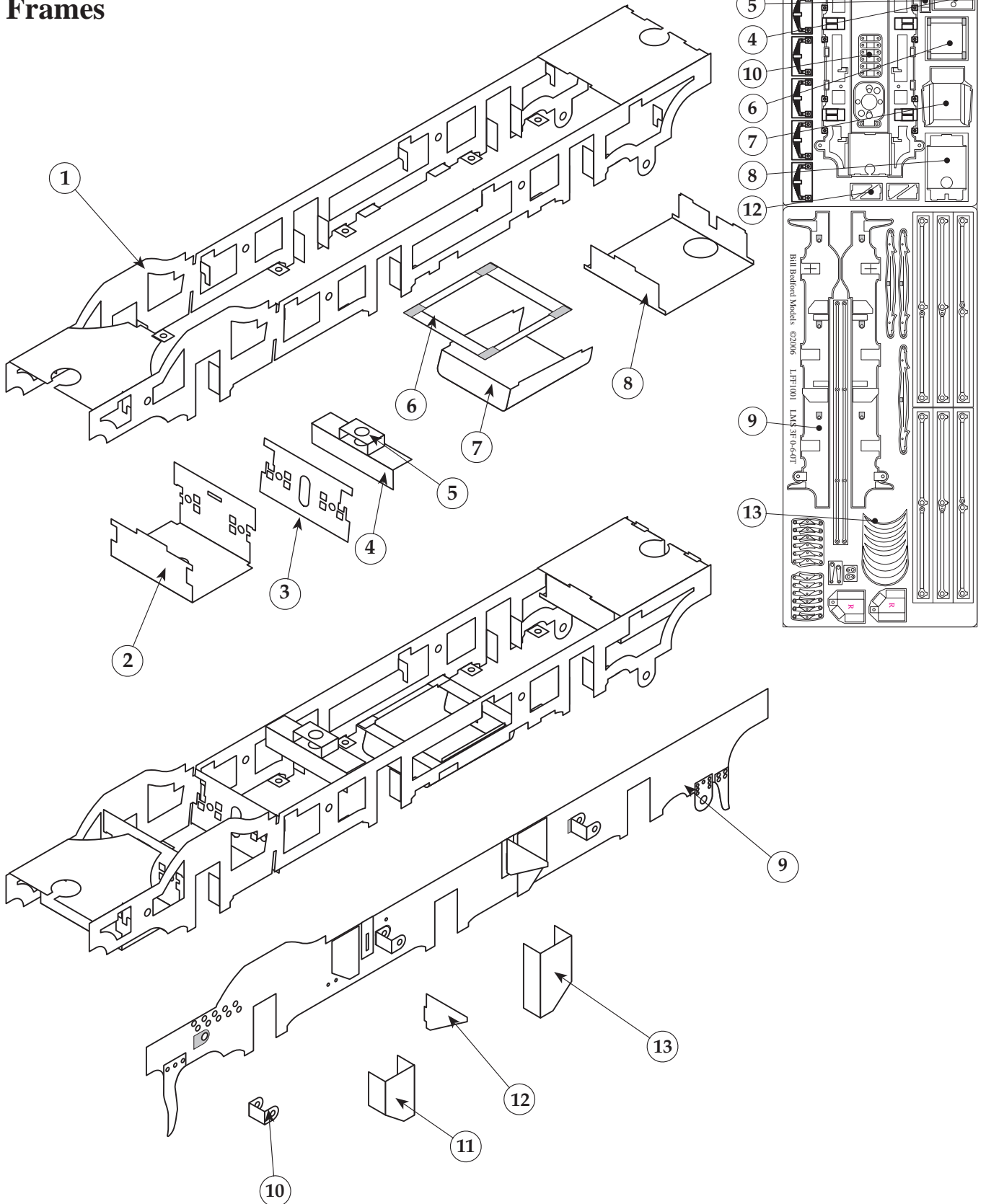

Coupling Rods

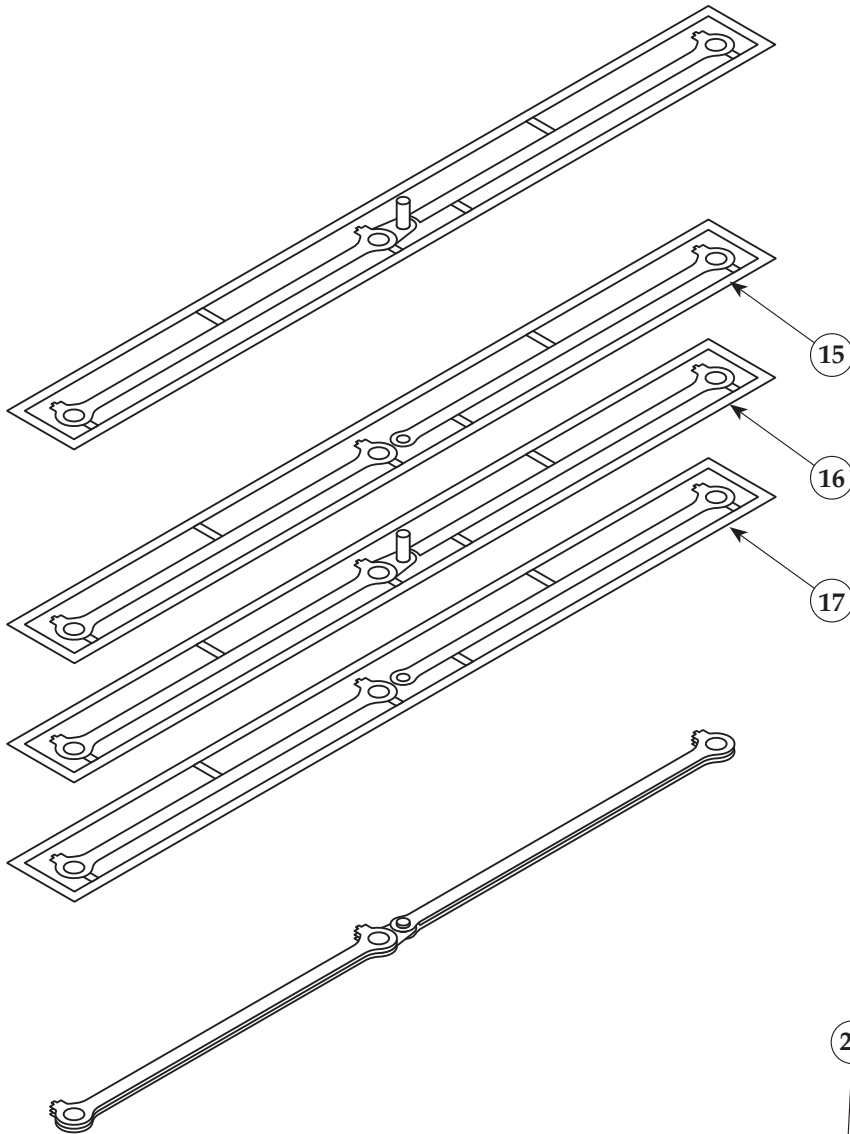

The coupling rods have been put into their own frames to facilitate their easy assembly.

Take a piece of hardwood, a offcut or sample of timber flooring is ideal, and drill a 1mm hole in it. Use a drill fixed in a stand or bench drill to ensure that the hole is square to the surface of the wood. The hole should be about 5mm deep.

Place a piece of 0.9mm brass wire into the hole and thread knuckle hole of the middle frame onto the wire. Solder the wire into the rod. Clean of any excess solder from the joint.

Assemble all three frames in order, and using the frames to align the rods solder them together ensuring that the knuckle pin is not soldered to the knuckle cheeks.

Remove the frame, trim off all the etching tabs, a piercing saw is recommended, and reduce the length of the knuckle pin

The crank pine holes can now be reamed to fit the crank pins.

Brake Rigging

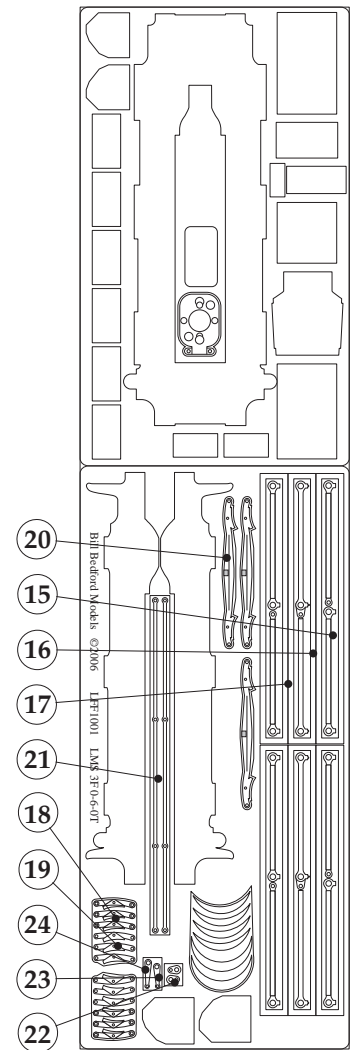
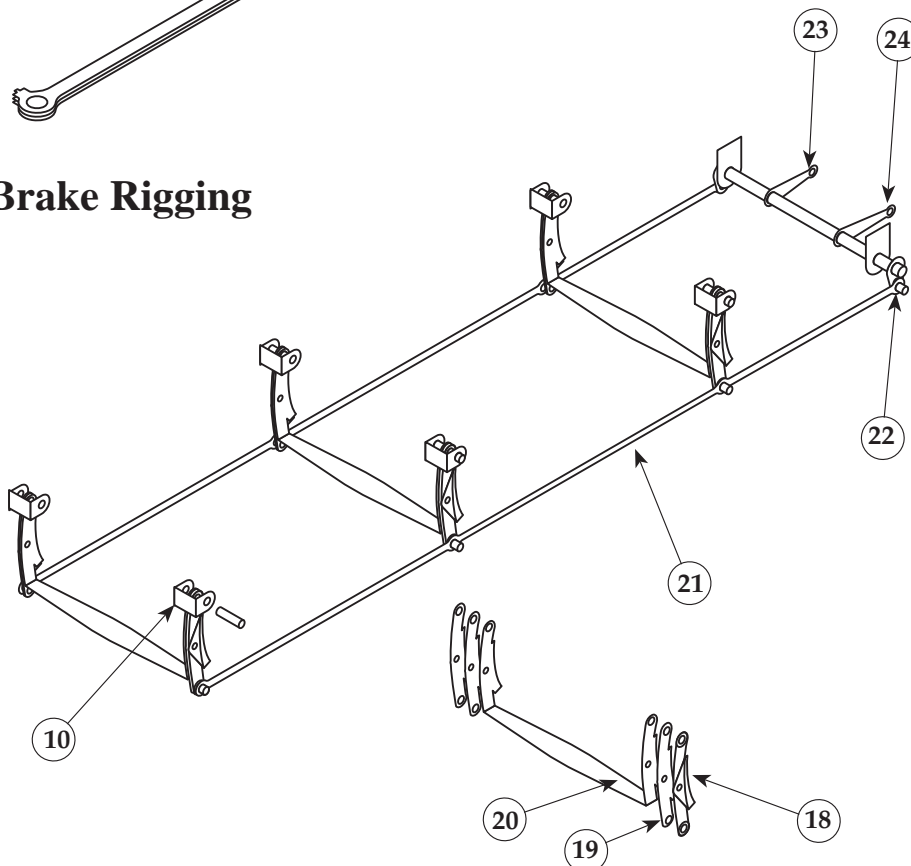

Finishing

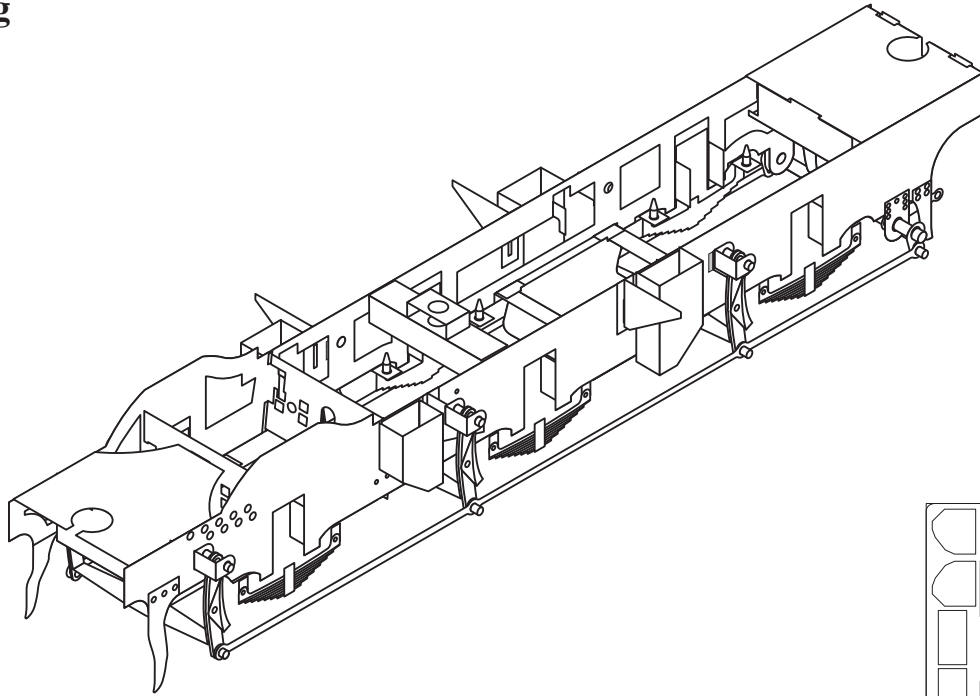

Motor Mount

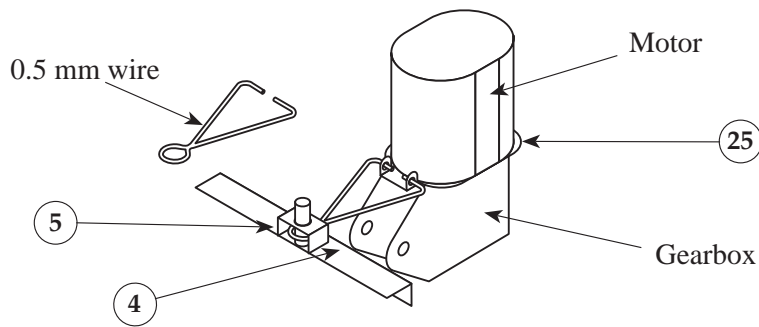

Suggestion for Motor mount / torque reaction arm
Not to scale

